

MS17HD4P4150-M

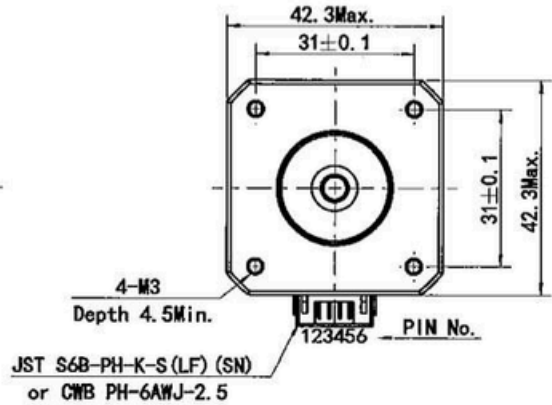

Wiring Diagram

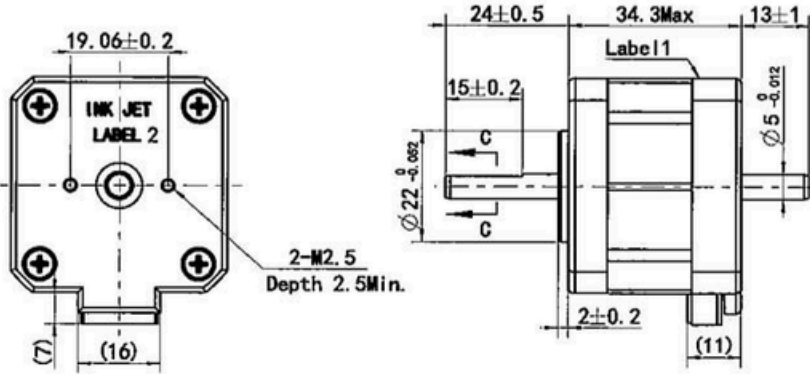
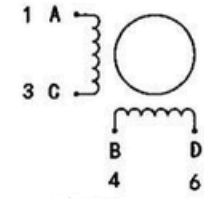

Exciting Sequence vs. Direction of Rotation

STEP	A	B	C	D	CW
1	+	+	-	-	↑
2	-	+	+	-	
3	-	-	+	+	
4	+	-	-	+	

Clockwise view from mounting side

**Label 1 Detail**

STEPPING MOTOR  
 Insulation: Class B, 60VDC Max.  
 1.5Amps Holding: 0.32Nm  
 3000RPM Max. **UL** US  
 UL FILE No. E465363 XXX Factory ID

**Label 2 Detail**

TYPE MS17HD4P4150-M  
 XXXXXXXX YY/MM/DD  
 Work Order Date Format

1. Number of Phase	2
2. Step Angle	1.8°
3. Rated Voltage	2.55 V DC
4. Rated Current	1.5 Amp
5. Holding Torque	0.32 Nm Typ. (Two phase on/rated current)
6. Phase Resistance	1.7 ohm ±10% (20°C)
7. Phase Inductance	2.9 mH ±20%(1kHz 1V rms)
8. Rotor Inertia	38 gcm <sup>2</sup>
9. Motor Weight	0.21 kg
10. Insulation Class	B (130°C)

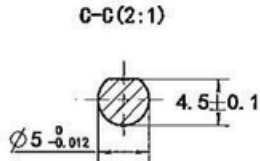

Unit:mm	First angle method	Approve	Standardize	Process Review	Check	Design
Tolerances for linear and angular dimensions without individual tolerance indications GB/T 1804-m eqv ISO 2768-1:m			UNLESS OTHERWISE SPECIFIED			
Geometrical tolerance for features without individual tolerance indications GB/T 1184-K eqv ISO 2768-2:K			NAMES SIGNATURE DATE			
REV.	REVISION RECORD	DATE	DRAWING No: 4611110011490 Rev. A2 SCALE: 1:1 Sheet 1 of 1			

